

VALENCIA

by Renegade

2022



Renegade
RV
REVGROUP

EXTREME LUXURY | EXTREME PURPOSE | EXTREME DURABILITY

Confidence to go anywhere

Renegade VALENCIA by Renegade

Family-friendly with the glamorous details you expect from Renegade, the Valencia has everything you need for fun and luxurious getaways. Solid hardwood cabinets, polished solid surface countertops and stainless steel appliances are just a few of the beautifully designed features you will find in this RV. Modern furniture and an abundance of storage throughout allows you to travel in comfort and style with the quality that comes with a Renegade.

Featured to the right:

Here we have the very popular Valencia 38BB (Driftwood Décor shown). This floor plan provides ample sleeping with the cabover bunk feature and the rear dual bunks. The fold out couch and dinette also provide additional sleeping accommodations. The kitchen includes a full size residential refrigerator and microwave.





THE *Renegade* VALENCIA AT A GLANCE

Exterior height	12'10"	Fuel capacity	100 Gallons
Exterior width	99¼"	Fresh water capacity	150 Gallons
Exterior length	35'8" - 38'2"	Grey water capacity	75 Gallons
Interior height	84"	Black water capacity	75 Gallons
Interior width	95½"	LP tank	20 Gallons
		DEF	10 Gallons



KEY FEATURES

- 360HP w/ 3000MH Allison Transmission
- Multiplex system with color touch panel & Bluetooth app control
- Four full paint color options
- Four-Point automatic hydraulic leveling system
- Electric lateral arm awning with integrated LED lights
- Solid hardwood cabinets and solid surface countertops

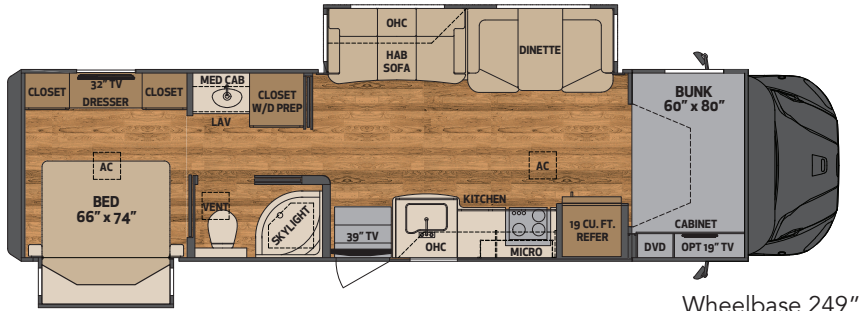

Wheelbase 249"

35MB 35' mid bath, 2 slides

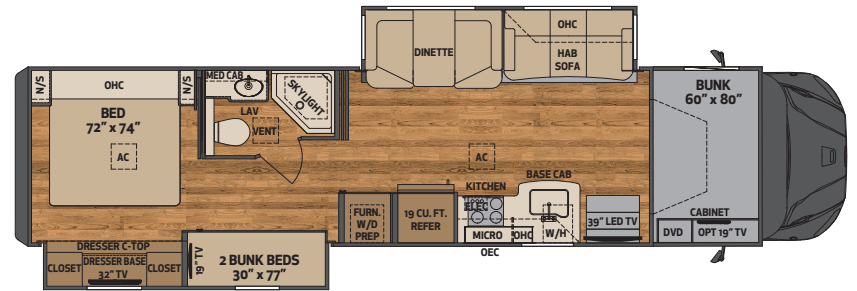

Wheelbase 279"

38BB 38' mid bath, bunk beds, 2 slides

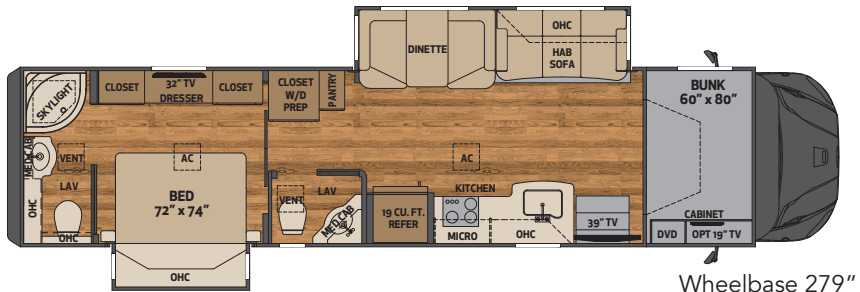

Wheelbase 279"

38RB 38' mid and rear bath, 2 slides

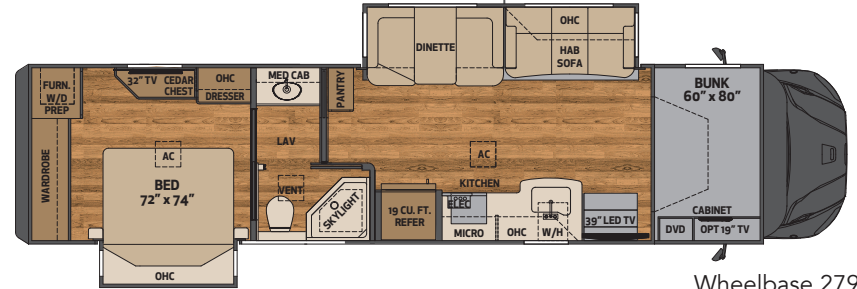

Wheelbase 279"

38RW 38' mid bath, rear wardrobe closet, 2 slides



ICED LATTE



CRACKED PEPPER



DRIFTWOOD

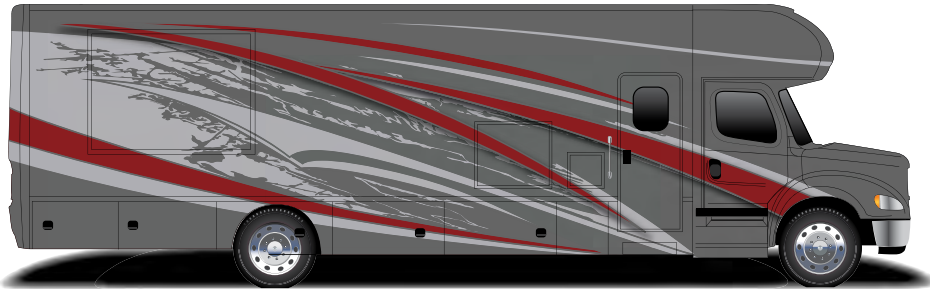

CRIMSON

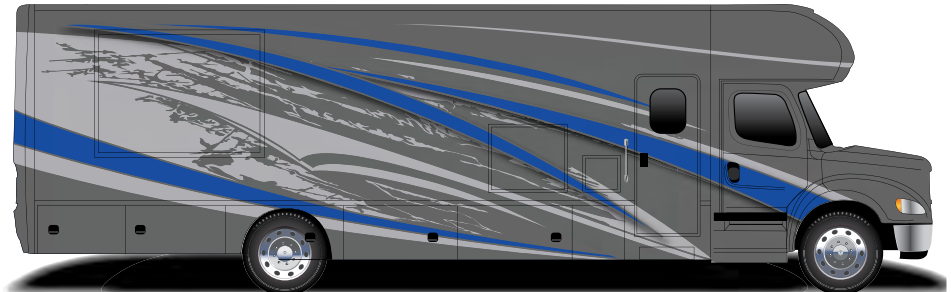

ROYAL



RUSSET

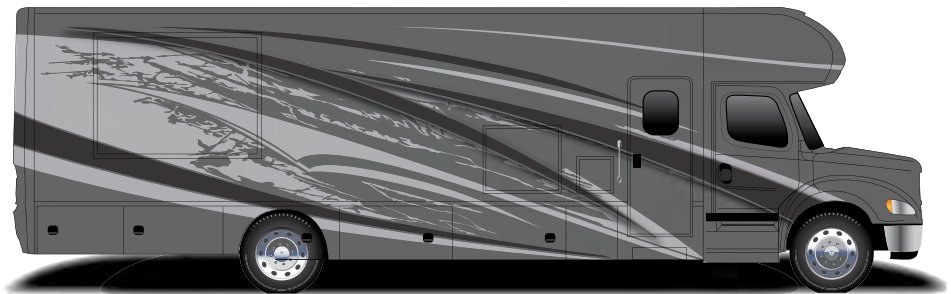

GRAPHITE

CAB/CHASSIS

Freightliner chassis S2RV 33,000 lb. GVWR, 46,000 lb. GCWR
Cummins ISB 6.7L 360HP, 800 lb. ft. torque
Allison 3000MH 6-speed automatic transmission with electronic push button shifter
Cummins VG engine braking with dash switch
Aluminum cab construction designed for occupant protection
One-piece panoramic cab windshield
Premium Freightliner heat/sound insulation package
Freightliner heavy duty chromed steel 3 piece front bumper
LED headlight assemblies
Power windows and door locks
Power/heated remote control mirrors
Tilt & telescoping steering wheel w/ electronic cruise control
Air ride driver and passenger seat pedestals with swivels
Soft touch driver/passenger seats w/ armrests
Full cab mat
Single 100 gallon fuel tank with side mounted fill - driver side
Airliner rear air ride suspension
Auxiliary air chuck and hose

CONSTRUCTION

2" vacuum bond laminated sidewalls w/ welded tubular aluminum framing
Welded tubular aluminum roof truss system w/ framed cutouts
One piece crowned fiberglass roof surface
"Super Sandwich" floor construction w/ galvanized vapor barrier includes:

- 3/4" fir plywood deck over 2 x 4 wood-framed residential floor
- 2" welded steel floor joist system
- Mounted to 3" steel longitudinal floor beams
- 3.5" premium grade sound deadening and thermal insulation in floor

EXTERIOR

Powder-coated steel storage compartments w/ carpeted lining
Exterior entry door assist handle
RV entrance door w/ screen, deadbolt, frameless window, & pleated shade
Girard GG lateral arm electric awning w/ LED lights
Aluminum wrapped auto deploy/retract awnings over all slide outs
12,000 lb. hitch, 7 way tow connector
LED brake, turn & high mount brake lights
Fiberglass molded cab entry steps

ELECTRICAL SYSTEMS

8KW Onan quiet diesel generator
Automatic generator start system
3,000W magnum hybrid inverter
(1) 8D AGM house battery
Multiplex lighting system with smartphone app
Solar charging system pre-wire
Central command center cabinet
50 amp electrical panel
12V holding tank heaters, grey & black tanks

INTERIOR

Soft touch sofa with queen size slide-a-bed sleeper
Soft touch dinette w/ convertible bed & solid surface table top
Premium vinyl flooring throughout
Premium hardwood cabinets w/shaker style doors
Satin nickel cabinet door and drawer pulls
Soft close full extension ball bearing drawer guides throughout
slide-out pantry with adjustable shelves (select floorplans)
Polished solid surface countertops throughout
Stonecast deep bowl kitchen sink with solid surface covers
Glass tile backsplash
LED wall and dinette décor lighting
Manual day/night roller shades
Energy efficient LED flush mount ceiling lighting throughout
Decorative vinyl wall covering with coordinating accent color in slide rooms
Designer bedspread w/ pillows
iRelax memory foam mattress (66" x 74" mini king-MB only)
(72" x 74" king-all except MB)
60" x 80" sliding cabover bunk sleeper with R/S window and media cabinet
Full length wardrobe w/removable bottom shelf & shoe storage (select floorplans)

APPLIANCES

18.0 cu.ft. residential stainless steel refrigerator with icemaker
Recessed sealed 3 burner stainless steel LP cooktop
Stainless steel convection microwave oven
35,000 BTU LP gas furnace with electronic ignition
10 gal. gas/electric water heater
(2) 15,000 BTU low profile roof A/C w/heat pumps, plumbed condensation lines
Ducted heating and air conditioning
Pre-wired & plumbed for optional washer/dryer
Carbon monoxide, LP & smoke detectors, fire extinguisher
Winterization kit

BATH

Deluxe hardwood vanity and medicine storage cabinets
Fiberglass shower with glass door
Shower skylight
12V high capacity on demand water pump
Whole house water filtration system
Polished solid surface countertop w/ solid surface sink
Deluxe satin nickel bath faucet & adjustable shower head

ENTERTAINMENT SYSTEM

Garmin touch screen, bluetooth, GPS, RV maps and color camera monitor
Upgraded cab sound system - JBL 5.25" Dash and 6.25" ceiling speakers
Sirius/XM ready (requires customer subscription)
Color rear and side view cameras
Soundbar home theater w/ bluetooth streaming and wireless subwoofer
40" LED TV in living area / 32" LED TV in bedroom
BluRay DVD player with remote in living area
Ext. Ent. Ctr. w/ 32" LED TV w/ soundbar on swivel, USB charging
Exterior park cable hookup
Rooftop antenna with standard and HD signal capability
Pre-wired for In-motion and HD rooftop satellite systems (boxes not included, TV & radio services requires customer subscription)

POPULAR OPTIONS

Theater seating
Storage ottoman
Three roof-mounted 175 watt (each) solar panels
Table with credenza and free standing dinette chairs
Premium one-piece vinyl floor in bedroom
Winegard In-motion satellite system
Winegard Trav'ler satellite system
LP quick disconnect LP line for gas grill
24" LED TV in cabover bed area
Brake controller
Diamond shield paint protection
13cu.ft. propane refer
W/D stack
Winegard 2.0 Antenna w/ Wi-Fi etc.

RENEGADE WARRANTY

Renegade MY 2022 motorhomes are covered by a 1-year unlimited miles limited warranty, plus a 3-year 36,000-mile limited structural warranty.

All Renegade motorhome chassis, engines and transmissions, and drivetrain warranties are provided and administered by their respective manufacturers.

For specific information about these warranties, ask your dealer or contact Renegade RV.



CELEBRATING 25 YEARS OF EXTREME LUXURY AND ADVENTURE

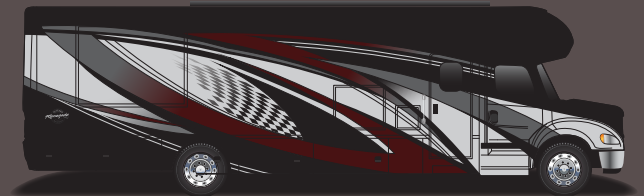

In celebration of 25 years, Renegade is offering a special 25th anniversary edition option of the Valencia.

Special Features Include:

- 25th Anniversary Paint Scheme with Special Edition Logo
- Limited Edition Unit # Badge
- Chrome Compartment Door Handles
- Custom 25th Anniversary Mudflap
- Custom 25th Wheel Hub Insert
- Embroidered Cab Seat Headrest
- 25th Anniversary Throw Pillows (2X)
- 25th Anniversary Slide Fascia Badging
- 25th Anniversary Multiplex Badging
- Pair of 25th "Proud Owner" Hats and Soft Shell Jackets

(Limited Availability)



Confidence to go anywhere

52216 SR 15 Bristol, IN 46507

888.522.1126 | RenegadeRV.com

Features and options may vary from descriptions without notice.