

Innovation meets  
diesel efficiency  
meets adventure.



ERA

**WINNEBAGO**



**On the Cover:** 70A Iridium Silver  
**Interior:** Fusion with Smoke with High Gloss Dark Canvas Cabinetry

## Our Original Sprinter B-Van Raises the Bar Again.

Since its launch more than a decade ago, the groundbreaking Winnebago® Era® has become synonymous with luxury travel, with exceptional comfort, stylish good looks and outstanding performance.

Now, the versatile Era brings a new round of innovation to the table, starting with its new Mercedes-Benz® Sprinter chassis. Powered by a fuel-efficient 3-liter, 6-cylinder turbo-diesel engine, the Era incorporates the latest Mercedes-Benz safety and Infotainment features. And for those who prefer the road less traveled, the 4x4 option is engineered to help you tackle off-roading with ease.

Three floorplans offer a variety of seating and sleeping options, each incorporating upscale touches like Corian® countertops, Ultraleather™ furnishings and dimmable LED lighting. The 70A seats four and sleeps up to three; the 70B seats six and sleeps two; and the 70X seats up to seven and sleeps two. Each floorplan includes a fully-equipped galley, wet bath, and well-configured storage options.



Beautiful, functional and fully equipped, the Era galley makes it easy to enjoy your favorite meals virtually anywhere.



The twin beds in the 70A feature Froli® springs for added comfort, and thanks to Winnebago's innovative Flex bed system, convert easily into a spacious queen bed.



Making the most of every square inch of space, the 70A offers a large cargo tray that's easily accessible from inside or outside the coach.



Featuring a movable pedestal table and swivel cab seats for additional seating options, the Era lounge is perfect for relaxing, socializing, or working. Multiple tinted windows offer expansive views; MCD blackout roller shades provide complete privacy when you want it. Set the lighting with the multiplex lighted wall switches or via the Precision Plex app for Android or iOS. When the weather turns, the reliable Truma Combi® Eco Plus heating lets you flex between gas and electric modes, and the new Coleman® Mach® 10 NDQ A/C system stays ultra-quiet while directional vents send cool air throughout the coach.



Swiveling cab seats



Sofa



24" HDTV

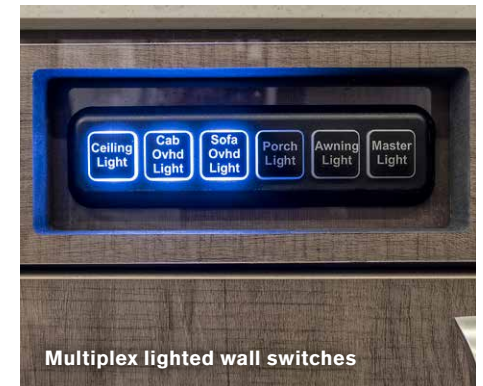

Multiplex lighted wall switches



The Era's elegant galley features Corian countertops, a two- or three-burner cooktop with glass cover, microwave or microwave-convection oven, stainless sink, compressor-driven refrigerator, and even a cold-water purification system — everything you need to prepare delicious meals whenever you want.



Countertop extension



Refrigerator



Microwave



Stainless steel sink



Cooktop with glass cover



The three Era floorplans provide a range of sleeping options. The 70A features twin beds with our Flex Bed system and deluxe Froli® springs; the beds flip up to provide access to the slide-out cargo tray. The 70A also includes a convertible sofa/bed up front for an overnight guest. Both the 70B and 70X incorporate a large powered rear sofa/bed, and all bedrooms feature an LED TV so you can settle in for a movie night from the comfort of your bed. The convenient wet bath includes a flexible showerhead, shower curtain, stainless steel sink, removable clothing rod and powered roof vent.



Flex bed system



Storage

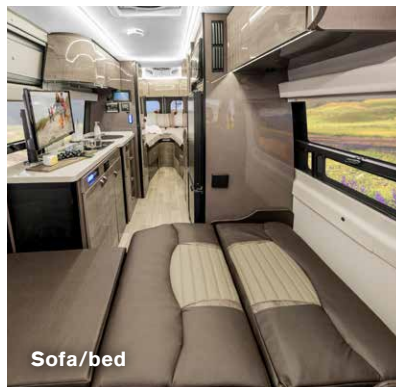

Sofa/bed

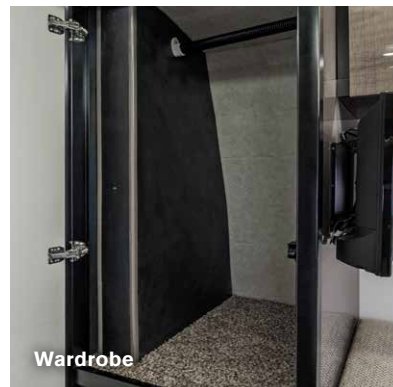

Wardrobe



Wet bath



Stainless steel sink

WINNEBAGO

**ERA**

# Exterior



The Era's attractive and sleek exterior is exceptionally functional in camp. Side and rear screen doors let breezes in while keeping bugs out, and the armless patio awning features automatic retraction in windy conditions (or use the Bluetooth® control to operate it remotely). LED porch light and awning lights illuminate your campsite, while the exterior speaker system lets you enjoy your favorite tunes while relaxing outside.



Side screen



Rear screen door



LED porch light



Running boards



The Era's fully adjustable cab seats let you hit the road in comfort. Once underway, take advantage of the advanced Mercedes-Benz safety features, including blind spot monitoring, collision avoidance system, active brake assist, crosswind assist, and headlight assist. The 10" MBUX® touchscreen multimedia infotainment center features navigation, interactive voice interface, Wi-Fi hotspot, and rear color camera monitoring system.



Dash storage



Privacy shades



Steering wheel



MBUX infotainment center



# 70A

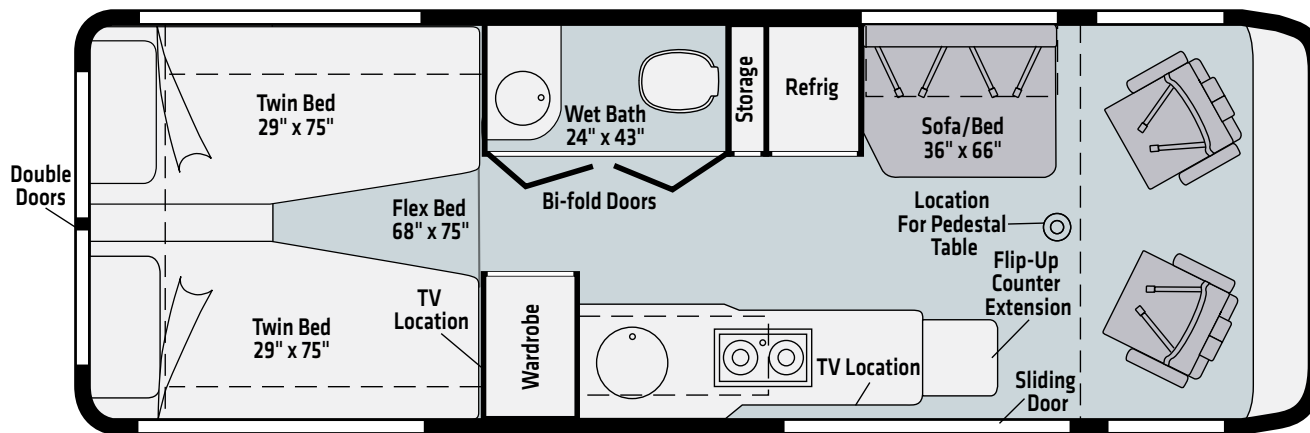





# 70B

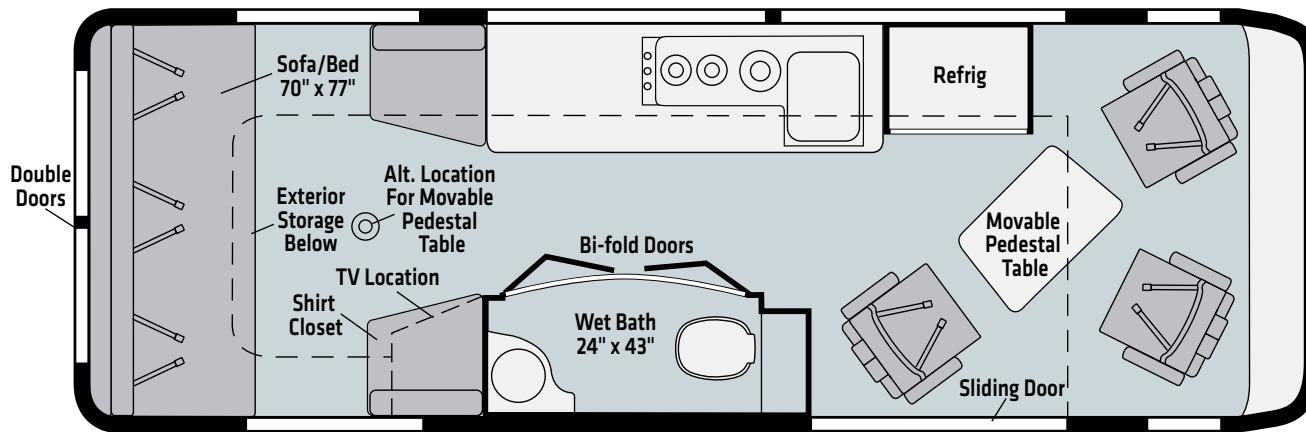

# 70X

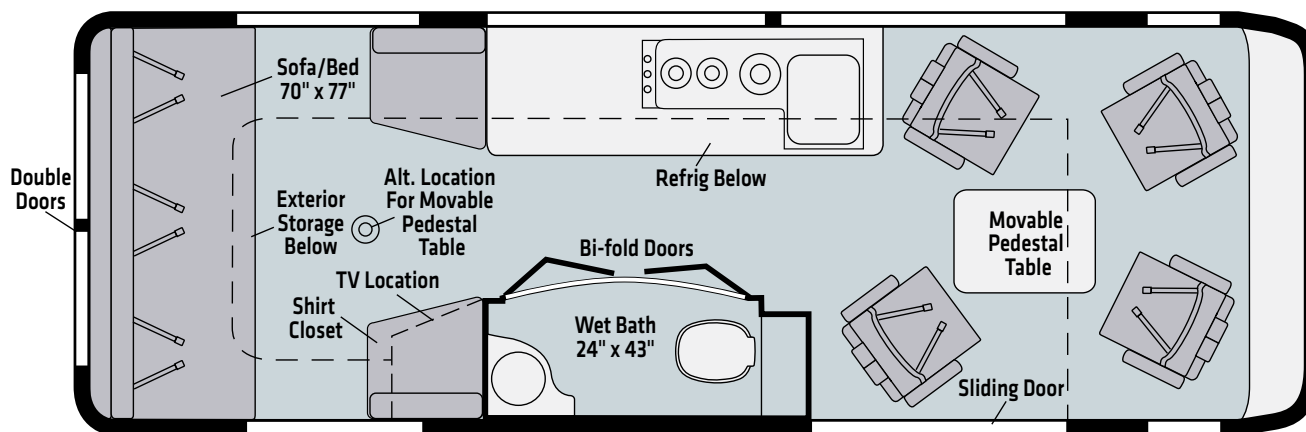

Dashed lines denote overhead storage areas. Floorplans and specifications are also available online at [Winnebago.com](http://Winnebago.com)

WINNEBAGO

**ERA**

**Exterior**



**Iridium Silver**  
FULL-BODY PAINT



**Tenorite Grey**  
FULL-BODY PAINT

## Fusion



Ultraleather



Wall Board



Bed Cover



Countertop

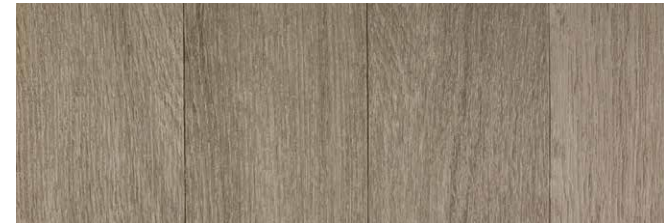

Vinyl Flooring

## Wood



Smoke with High Gloss Dark Canvas

Winnebago® reserves the right to change décor materials and specifications without notice or obligation.

## Quantum

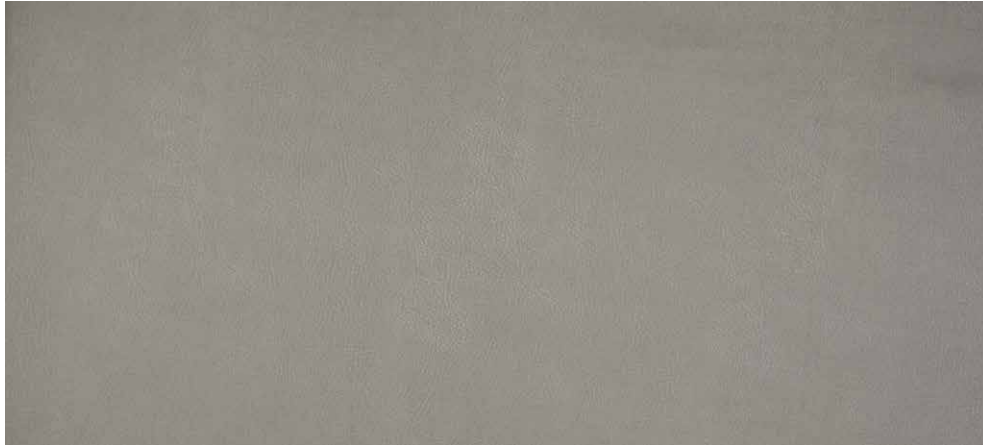

Ultraleather

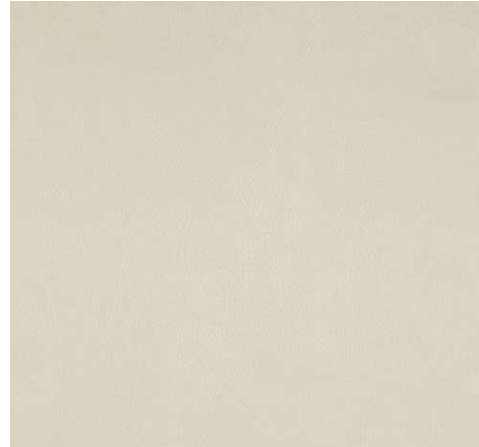

Wall Board



Bed Cover



Countertop

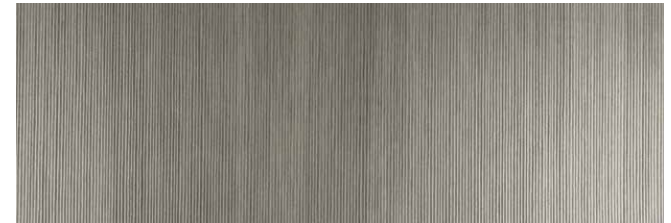

Vinyl Flooring

## Wood



Onyx

Winnebago® reserves the right to change décor materials and specifications without notice or obligation.



| WEIGHTS & MEASURES                                           | 70A                                   | 70B                                   | 70X                                   |
|--------------------------------------------------------------|---------------------------------------|---------------------------------------|---------------------------------------|
| <b>Length</b>                                                | 24'3"                                 | 24'3"                                 | 24'3"                                 |
| <b>Exterior Height<sup>1</sup></b>                           | 9'8" <sup>A</sup> /9'10" <sup>B</sup> | 9'8" <sup>A</sup> /9'10" <sup>B</sup> | 9'8" <sup>A</sup> /9'10" <sup>B</sup> |
| <b>Exterior Width</b>                                        | 6'4.25"                               | 6'4.25"                               | 6'4.25"                               |
| <b>Awning Length</b>                                         | 16'                                   | 16'                                   | 16'                                   |
| <b>Interior Height</b>                                       | 6'3"                                  | 6'3"                                  | 6'3"                                  |
| <b>Interior Width</b>                                        | 5'9.75"                               | 5'9.75"                               | 5'9.75"                               |
| <b>Freshwater Tank Capacity<sup>2</sup> (gal.)</b>           | 25                                    | 25                                    | 25                                    |
| <b>Water Heater Capacity (gal.)</b>                          | 2.6                                   | 2.6                                   | 2.6                                   |
| <b>Holding Tank Capacity - Black/Gray<sup>2</sup> (gal.)</b> | 8/26                                  | 9/19                                  | 9/19                                  |
| <b>LP Capacity<sup>3</sup> (lbs.)</b>                        | 67.68                                 | 67.68                                 | 67.68                                 |
| <b>Fuel Capacity (gal.)</b>                                  | 24.5                                  | 24.5                                  | 24.5                                  |
| <b>GCWR<sup>4</sup> (lbs.)</b>                               | 15,250                                | 15,250                                | 15,250                                |
| <b>GVWR (lbs.)</b>                                           | 11,030                                | 11,030                                | 11,030                                |
| <b>GAWR - Front (lbs.)</b>                                   | 4,410                                 | 4,410                                 | 4,410                                 |
| <b>GAWR - Rear (lbs.)</b>                                    | 7,720                                 | 7,720                                 | 7,720                                 |
| <b>Wheelbase</b>                                             | 170"                                  | 170"                                  | 170"                                  |

\* Quick Recovery Truma Combi™ water/coach heater system runs on LP and/or 110-volt electric (includes 2-850-watt heating elements)

<sup>A</sup> Standard Chassis    <sup>B</sup> Optional 4WD Chassis

## Mercedes-Benz® Sprinter Chassis

**3.0L 6-cylinder, 188-hp, turbo-diesel engine, 7G-Tronic automatic transmission, 220-amp. alternator**

**4-wheel ABS brakes**

**Stylized aluminum wheels**

**Trailer hitch<sup>4</sup> 5,000-lb. drawbar/500-lb. maximum vertical tongue**

**7-pin wiring connector**

**Spare tire**

### OPTIONAL EQUIPMENT

**On-demand 4WD w/Hi/Lo Range**

## Cab Conveniences

**MBUX® touchscreen multimedia**

**infotainment center w/navigation, Wi-Fi hotspot, intelligent voice control and rear camera**

**Ultraleather® cab seats** armrests, adjustable lumbar support, adjustable headrest, and slide/swivel/recline

**3-point seat belts**

**Dual airbags**

**Power steering w/tilt and telescoping wheel**

**Power mirrors w/defrost and turn signal**

**Power door locks w/remote**

**Power windows**

**12-volt powerpoints**

**Sunvisors**

**Folding privacy screens for front cab door windows**

**Appliqué package**

**Keyless entry w/remote**

**Blind spot monitoring**

**Collision avoidance system**

**Active brake assist**

**Traffic sign assist**

**Crosswind assist**

## Interior

**24" HDTV** (70A swivels for outdoor viewing)

**OmniGo™ omni-directional, amplified HDTV antenna**

**Continuous tracklighting w/dimmer switch**

**MCD® blackout roller shades**

**Soft vinyl ceiling**

**Tinted coach windows**

**Removable companion seats w/swivel and slide** (70B, 70X)

**Removable pedestal table**

**Sofa/bed** (70A)

**Touch screen systems monitor panel**

**Multiplex lighted wall switches** w/master light switch and control via Precision Plex app for Android/iOS

**Mirror**

**USB charging points**

**Deluxe powered ventilator fan w/rain cover**

### OPTIONAL EQUIPMENT

**Front cab air mattress 30" x 65"** w/support base, cordless pump, repair kit and storage bag

## Galley

**Flip-up countertop extension** (70A)

**Corian® solid-surface countertop**

**Decorative backsplash** (70B)

**Microwave oven** w/touch control (70A)

**Microwave convection oven** w/touch control (70B, 70X)

**2-burner range top** w/glass cover (70A)

**3-burner range** w/glass top and stainless steel sink (70B, 70X)

**5.5 cu. ft. (12V) 2-door compressor-driven refrigerator/freezer** (70A)

**6.0 cu. ft. (12V) 2-door compressor-driven refrigerator/freezer** (70B)

**4.3 cu. ft. (12V) single door compressor-driven refrigerator/freezer** (70X)

**Stainless steel sink** w/folding faucet and glass cover (70A)

**Bamboo sink cover and cutting board** (70B, 70X)

**Cold water purification system**

## Bath

**Wet bath** 24" x 43"

**Flexible showerhead**

**Shower curtain**

**Toilet w/foot pedal and sprayer**

**Tissue holder**

**Stainless steel sink**

**Powered roof vent**

**Removable clothing rod**

**Shower mat**

## Bedroom

**Twin beds** w/Flex Bed System (70A)

**24" HDTV** w/remote (70A)

**Wardrobe** (70A)

**Powered sofa/bed** (70B, 70X)

**Deluxe sleep system** (70A)

## Exterior

**Sliding entrance door**

**Side screen door**

**Rear screen door**

**Powered patio awning** w/LED lighting

**Slideout compartment tray** (access from rear door) (70A)

**Porch light** w/interior switch

**Running boards, rocker trim** w/mud guard

**Rear mud guards**

**Exterior speaker system**

### OPTIONAL EQUIPMENT

**Luggage rack**

**Ladder**

## Heating & Cooling System

**Coleman®-Mach® 10 NDQ air conditioner** interior shroud w/directional vents

**Truma Combi® Eco Plus Heating System** w/(2) 850-watt electric heating elements



## Electrical System

**AC/DC load center/converter**

**2-deep cycle Group 31 batteries** (AGM maintenance free)

**Coach battery disconnect system**

**200-watt solar panel/battery charger**

**45-amp. converter/charger**

**30-amp. power cord**

**Exterior TV jack**

**Exterior AC/DC receptacles**

**2,500-watt Cummins Onan® MicroQuiet™**

**LP generator**

**1,000-watt Pure Sine Wave inverter**

## Plumbing System

**Exterior Service Center** city water hookup/tank diverter valve, drainage valves, sewer hose (w/shut-off 70B, 70X) valve and exterior wash station w/pump switch

**TrueLevel™ holding tank monitoring system**

**Winterization Package** water heater bypass valve and siphon tube

**On-demand water pump**

**12-volt macerator sewage pump** (70B, 70X)

**Permanent-mount LP tank** w/gauge

**LPG accessory connection**

**Holding tank flushing system**

## Safety

**Child seat tether anchors** (70B, 70X)

**LP, smoke, and carbon monoxide detectors**

**Fire extinguisher**

**Ground fault interrupter**

**Daytime running lamps**

## Warranty<sup>5</sup>

**12-month/24,000-mile basic warranty**

### FOOTNOTES

1. The height of each model is measured to the top of the tallest standard feature and is based on the curb weight of a typically equipped unit. The actual height of your vehicle may vary by several inches depending on chassis or equipment variations. Please contact your dealer for further information.
2. Capacities are based on measurements prior to tank installation. Slight capacity variations can result due to installation applications.
3. Capacities shown are tank manufacturer's listed water capacity (W.C.). Actual filled LP capacity is 80% of listing due to overfilling prevention device on tank.
4. Actual towing capacity is dependent on your particular loading and towing circumstances which includes the GVWR, GAWR, and GCWR, as well as adequate trailer brakes. Please refer to the Operator's Manual of your vehicle for further towing information.
5. See separate chassis warranty.
6. See your dealer for complete warranty information.

NA Not Available

Not all items available in combination. See dealer for details.

Because features, specifications, equipment, and options may vary from those highlighted in this brochure, the buyer is responsible for confirming with the dealer the features, specifications, equipment, and options included on their specific vehicle. In addition, Winnebago's program of continuous product improvement may result in changes to vehicle specifications, equipment, model availability, and price without notice.